

Premium Booth 3mW x 5mD One side open

WJ-A-15 - 3mW x 5mD x 3.5mH

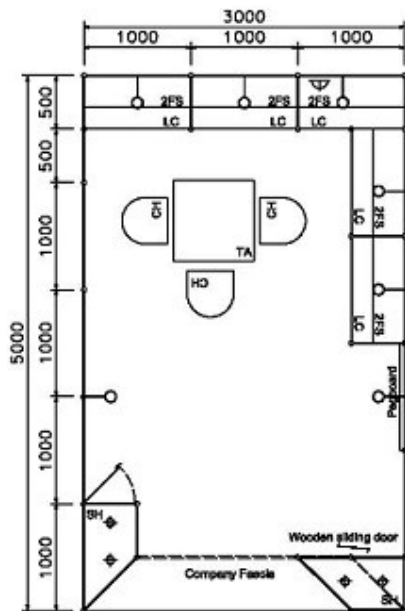

PLAN

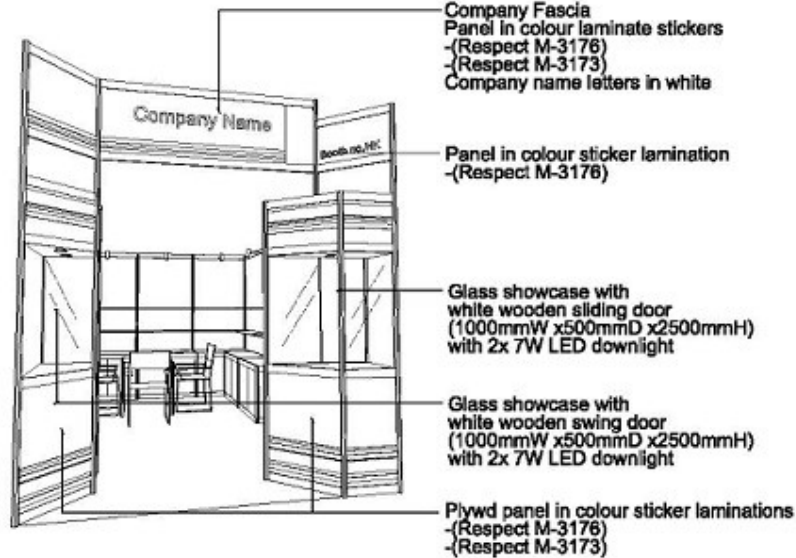

PERSPECTIVE N.T.S.



COLOUR PERSPECTIVE N.T.S.

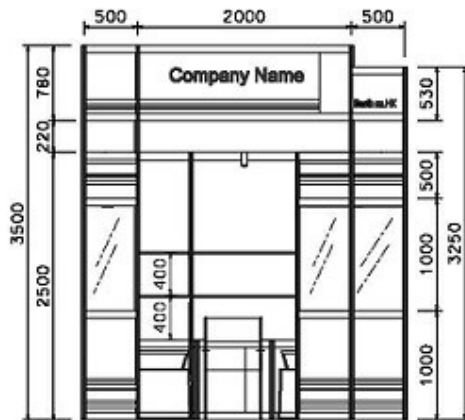

FRONT ELEVATION

BOOTH SPECIFICATION		QTY
	Front glass showcase in sticker lamination with white wooden swing door. 2 x 7W LED downlight (1mW x 0.5mD x 2.5mH)	1
	Front glass showcase in sticker lamination with white wooden sliding doors. 2 x 7W LED downlight (1mW x 0.5mD x 2.5mH)	1
	Lockable cabinet (1mL x 0.5mD x 0.75mH)	5
	Wooden shelf (flat) (1mL x 0.3mD)	10
	Pegboard with 30 hooks (1mW x 2.5mH)	1
	Square meeting table (0.7m X 0.7m x 0.75mH)	1
	Black leather chair	3
	Longarmed spotlight w/. 13W LED lamp (yellow)	7
	500w Square pin power socket	1

FILE PATH - \\10.10.8.25\Structure_Permanent\Detail\Local Fab - Premium Booth - 2011\WJ-A-15 layout\WJ-A-15.dwg



NOTES UNLESS OTHERWISE SPECIFIED ALL DIMENSIONS ARE IN MM.

.....

REVISION
 15-05-2019
 23-10-2019
 20-01-2019
 01-03-2019
 31-12-2019

DATE: 03-05-2019
 SCALE: 1 : 50 (A3)
 DRAWN BY: ..
 CHECKED BY:

TITLE
 Premium Booth
 WJ-A-15

PROJECT
 PREMIUM BOOTH
 3m x 5m
 DATE: XXXXXXXX

SHEET
 WJ-A-03