

**Special Circular 1 Move in/out Arrangement & Use of Vehicle Pass for the HKTDC Hong Kong International Diamond, Gem & Pearl Show 2025**

Dear Exhibitors,

Thank you for your participation at the coming HKTDC Hong Kong International Diamond, Gem & Pearl Show. There will be special traffic arrangements to minimize the traffic pressure on the **move-in day (1 March 2025)** and **move-out day (6 March 2025)**. These measures would be beneficial to both our valued exhibitors as well as the general public.

Please be advised that there will be special traffic arrangements applied at the roads of the AsiaWorld-Expo (AWE) on the move-in day (1 March) and move-out day (6 March). All Lorries/ Light Goods Vehicles must first report to the vehicle **Expo Marshalling Area at Shun Fai Road**. Please kindly pay attention to the details of the arrangement as below:-

**(A) Vehicle Pass for Lorries / Light Goods Vehicles**

A new e-permit system is implemented under the new arrangement of AsiaWorld-Expo. e-Vehicle permits will be issued by separate email to each exhibitor for entering the loading /unloading area of the AsiaWorld-Expo on the move-in day (1 March) and throughout the exhibition period including the move-out day (2 – 6 March). The permit is **only valid for use at the specified dates and times** indicated on the permit. Each e-Vehicle permit can only be **used once only**, either by showing the QR code in phone/tablet or in printed version.

**Conditions**

1. All vehicles without a valid Goods Vehicle Permit will not be permitted to enter into the premises of AsiaWorld-Expo (hereinafter "AWE")
2. The driver must comply with instructions from the security personnel at all times within AWE.
3. The Goods Vehicle Pass is not transferable.
4. AWE or its authorized person(s) reserve the right to refuse entry of any vehicle in possession of a valid Goods Vehicle Permit at their absolute discretion without prior notice and giving reason.
5. All drivers must stay inside their vehicles at all times.
6. For articulated vehicles, only those containers and trailers are 40 feet or below will be allowed to enter AWE. The Vehicle Pass is not suitable for parking purpose, and is not valid for private cars.

**The e-Vehicle Permit is valid for 7-seater Private Vehicle. Loading and unloading time limit for 7-seater Private Vehicle is 30 minutes. Goods vehicles (including 7-seater Private Vehicle) are NOT allowed to enter the East & West Entrance.**

**Move-In Day Arrangement for Vehicles on 1 March 2025**

Goods vehicles will **only be allowed** to enter into the AWE loading/unloading area with:-

- (a) **Goods Vehicle Pass** issued by HKTDC **AND** (b) **Entry pass** issued at the Expo Marshalling Area

**Move-in procedure**

1. HKTDC issues Move-in e-Vehicle permit to all exhibitors in February 2025.
2. Before proceeding to the AWE loading/unloading area, all vehicles **MUST** first report to the **Expo Marshalling Area at Shun Fai Road** according to the time specified on the vehicle pass issued by HKTDC. The Expo Marshalling Area will be opened at 8:00 a.m. until all the move-in activities finished. The location of the Expo Marshalling Area will be at Shun Fai Road. (Please refer to the attached map for the exact location)
3. Upon arrival at the Expo Marshalling Area, the drivers **MUST** first present the e-Vehicle permit issued by HKTDC, queue up after registration and wait for further instructions given from the security personnel. The waiting time at the Expo Marshalling Area may vary and would depend on the total number of vehicles, move-out speed and the prevailing traffic condition.
4. According to the traffic condition, an **Entry pass** will be issued to the drivers at appropriate time. The driver must then proceed to AWE loading/unloading area via Chek Lap Kok Road **within 30 minutes** with:-

- a. **Goods e-Vehicle Permit** issued by the HKTDC **AND**
- b. **Entry pass** issued at the Expo Marshalling Area

5. Drivers **failing** to present the above 2 passes will **NOT** be allowed to enter into AWE loading/unloading area.

**Move-Out Day “Special Arrangement” for Vehicles on 6 March 2025**

Entries of the AWE will only be allowed to the goods vehicles with:-

(a) **Goods e-Vehicle Permit** issued by HKTDC **AND** (b) **Entry pass** issued at the Expo Marshalling Area

**Move-out procedure**

1. Control point will be set-up at the entrance of AWE, only the vehicles with the
  - a. **Move-out Goods e-Vehicle Permit** issued by the HKTDC **AND**
  - b. **Entry pass** issued at the Expo Marshalling Area
 are allowed to enter the AWE **after 5:00 p.m.** on 6 March.
2. Before proceeding to the AWE loading/unloading area, all vehicles **MUST** first report to the **Expo Marshalling Area** (i.e. Shun Fai Road, please refer to the attached map for the exact location). The Expo Marshalling Area will be opened at 2:00 p.m. until all the move-out activities finished.
3. Upon arrival at the Expo Marshalling Area, the drivers **MUST** first present the Goods Vehicle Pass issued by HKTDC, queue up and wait for the further instructions given from the security personnel. The waiting time at the Expo Marshalling Area may vary and would depend on the total number of vehicles, move-out speed and the prevailing traffic condition.
4. After 5:00 p.m. on 6 March 2025, an **Entry pass** will be issued to the drivers at appropriate time. The driver must then proceed to AWE loading/unloading area via Chek Lap Kok Road **within 30 minutes**
  - a. **Move-out Goods e-Vehicle Permit** issued by the HKTDC **AND**
  - b. **Entry pass** issued at the Expo Marshalling Area
5. If the Expo Marshalling Area becomes overloaded, AWE will implement further measures at discretion.

*\*The Expo Marshalling Area will open from 2:00 p.m. on 6 March 2025 and operate until all move-out activities have finished*

Vehicles will be given a ticket with the clock-in time when entering the AWE loading/unloading area. With an aim of alleviating the traffic congestion due to a high usage of loading/unloading facilities, the free-of-charge loading/unloading time during the fair period is limited to 45 minutes.

AsiaWorld-Expo will impose charges on vehicles with extended stay on 1 March and 6 March 2025. The charges are as follows:

Vehicle Type	Grace Period	Overtime Charges
Private Car (7 seaters only):	30 minutes	1 <sup>st</sup> Hour or part thereof: HK\$300
Good Vehicle (8 Tons or below):	45 minutes	2 <sup>nd</sup> Hour and thereafter: HK\$500 per hour or thereof
Good Vehicle (over 8 tons):	90 minutes	

Payment (if any) will be collected at the exit control booth with official receipt. Please note that vehicle passes are not suitable for parking purpose, and is not valid for private cars.

**(B) Private Car / Taxi**

Private cars and taxis will be allowed to enter into the AWE at the discretion of the traffic control attendants during the move-in and move-out periods. No waiting or parking at the AWE is allowed. Private cars and taxis entering AWE will NOT be required to present any Vehicle Pass nor report to the Expo Goods Staging Area. However, drivers can only unload their goods at the entrance of the AWE.

**(C) Armored Vehicles**

Armored Vehicles associated with valuables are **not required** to queue up at Expo Marshalling Area on the move-in day on 1 March and move-out day on 6 March 2025.

**(D) Other Transportation**

Free shuttle bus service from will be provided. Exhibitors with hand-carry or light-weight exhibits may consider leaving the venue by taking the shuttle bus. Please wear your badge for identification purpose and the seats are provided on a first-come-first-served basis.

The above measure has been implemented in a number of exhibitions, and was proven to be effective in alleviating the traffic congestion. Please contact the Organiser for any further inquiries.

Thank you for your understanding and cooperation.

## 特別通告 1

## 進館、撤館及交通安排及貨車許可證之使用須知

## - 香港貿發局香港國際鑽石、寶石及珍珠展 2025

多謝參加香港貿發局香港國際鑽石、寶石及珍珠展2025，本局將於上述展覽會之進館日（即2025年3月1日）及撤館日（即2025年3月6日）實行特別交通安排，以舒緩其引起之交通擠塞及為各參展商及公眾人士帶來更大的方便。敬請留意以下詳情。

亞洲國際博覽館的所有道路將於進館日（即2025年3月1日）及撤館日（即2025年3月6日）起實施車輛進入管制。所有貨車及輕型客貨車必須先到位於南商用停車場之博覽館貨車等候區報到。請各參展商注意以下之特別安排。

**(一) 貨車 / 輕型客貨車 車輛許可證**

每家參展商均會獲發一張電子車輛許可證，方便於展品進場日（即3月1日）及展覽期間（3月2至6日）進入亞洲國際博覽館之裝卸區。此證只適用於許可證上指定之日期及時間，且每張電子車輛許可證只能使用一次。可用電話或電腦顯示二維碼（QR Code）入場，亦可選擇列印版本。

**車輛許可證之使用守則**

1. 沒有此電子車輛許可證之貨車一概不准進入亞洲國際博覽館貨車調度區。
2. 在博覽館範圍內，司機必須時刻遵從在場職員指示。
3. 此證不得轉讓他人使用。
4. 場館或授權人士可在沒有預先通知的情況下，拒絕持有此證之車輛進入。
5. 司機必須留在車上。
6. 如使用掛接式車輛，只有 40 英尺或以下的貨櫃和拖車才允許進入亞洲國際博覽館。此證並非泊車證，亦不適用於私家車。  
\*\* 電子車輛許可證可供七人私家車使用，上落貨時限為 30 分鐘，載貨用途之七人私家車嚴禁進入東面及西面入口。

**進館日(3月1日)之車輛「特別安排」**

必須同時持有 (a.)由貿發局發出之電子車輛許可證及 (b.) 由博覽館貨車調度區發出之進出證明書，方可進場。

**進場程序**

1. 香港貿發局於二月中向各參展商發出 3 月 1 日之進場電子車輛許可證。
2. 在進入亞洲國際博覽館貨物起卸區前，所有貨車及輕型客貨車必須在電子車輛許可證上之指定時間到博覽館貨車調度區報到。(博覽館貨車調度區位於順暉路，詳情請參考附圖)。車輛等候處將於 3 月 1 日上午 8 時開放，直至所有進場程序完成。
3. 當貨車及輕型客貨車到達貨車調度區後，必須出示由貿發局發出適用於該時段之電子車輛許可證，並於貨車調度區排隊等候指示。輪候時間將視乎車輛數量、進場速度及當日之交通情況而定。
4. 貨車調度區之職員將根據交通情況向輪候之司機發出一張進出證明書。司機攜同:-  
a) 電子車輛許可證 及 b) 進出證明書  
於 30 分鐘內經赤鱸角路前往亞洲國際博覽館貨物起卸區。
5. 未能提供上述兩種證件者將均不能進入亞洲博覽館貨物起卸區。

### 撤館日(3月6日)之車輛「特別安排」

必須同時持有 (a.) 由貿易發局發出之電子車輛許可證 及 (b.) 由博覽館貨車等候區發出之進出證明書

#### 撤場程序

1. 於撤館當日於臨近亞洲國際博覽館路段設置控制點，只准同時持有 a) 由香港貿易發局所發出之撤館電子車輛許可證 及 b) 博覽館貨車調度區發出之進出證明書之貨車於下午五時後駛進亞洲博覽館進行撤館。
2. 在進入亞洲國際博覽館貨物起卸區前，所有車輛必須先到博覽館貨車調度區報到。貨車調度區將於2025年3月6日，由下午2時開放至所有撤館程序完成。
3. 當車輛到達車輛等候處後，必須出示由貿易發局發出適用於該時段之電子車輛許可證，並於貨車調度區排隊等候指示。輪候時間將視乎車輛數量、撤場速度及當日之交通情況而定。
4. 貨車調度區將於下午5時開始，根據交通情況向輪候之司機發出一張進出證明書。司機應攜同  
**a) 由貿易發局發出之電子車輛許可證 及 b) 博覽館貨車調度區發出之進出證明書**於30分鐘內經赤鱸角路前往亞洲博覽館貨物起卸區。(根據車輛許可證之類別而定)
5. 如車輛等候超出可停泊車輛數目時，博覽館貨車調度區將酌情採取進一步措施。  
*\*車輛等候處將於2025年3月6日下午2時開放至所有撤館程序完成。*

當車輛進入亞洲國際博覽館貨物起卸區時，司機會收到一張印上進場時間的計時咭。為有效舒緩當日貨物起卸區交通緊張的情況，免費上落貨限時為**45分鐘**。亞洲國際博覽館將於**3月1及3月6日**實施進場車輛使用時間收費計劃。有關收費如下：

車輛類型	限時上落貨時間	超時收費
載貨用途之七人私家車	30分鐘	首小時或不足一小時為：港幣\$300元整
貨車(8噸或以下)	45分鐘	其後每小時為：港幣500元整
貨車(8噸以上)	90分鐘	(不足一小時亦當作一小時計算)

繳交費用(如適用)將於出口管制處辦理，並同時發還收據。許可證並非泊車證，亦不適用於私家車。

### (二) 私家車 / 的士進場程序

於進館及撤館期間將酌情准許的士及私家車駛入亞洲博覽館範圍，但不得停留或候客。進入亞洲國際博覽館之私家車及的士不需要持有貨車許可證或到博覽館貨車等候區報到，惟所有私家車及的士只能於正門進行落貨。司機於落貨後必須盡快離開亞洲國際博覽館，不得停留或候客。

### (三) 押運車進場程序

載有展品之押運車於進館日(3月1日)及撤館日(3月6日)並不需要到博覽館貨車等候區輪候。

### (四) 其它交通安排

大會亦於撤館期間安排免費穿梭巴士。持有輕量貨物之參展商亦可考慮以此方法撤館，請佩帶入場證以資識別。巴士座位有限，額滿即止。以上的安排已在早前的數個展覽會實施，並能有效地紓緩當日的交通情況。如有查詢，請與主辦機構聯絡。

多謝各參展商之諒解及合作。



HKTDC Hong Kong International Diamond, Gem & Pearl Show 2025

香港貿發局香港國際鑽石、寶石及珍珠展2025

(2 - 6 / 3 / 2025)

Overall Freight Routing 前往起卸區之路線圖

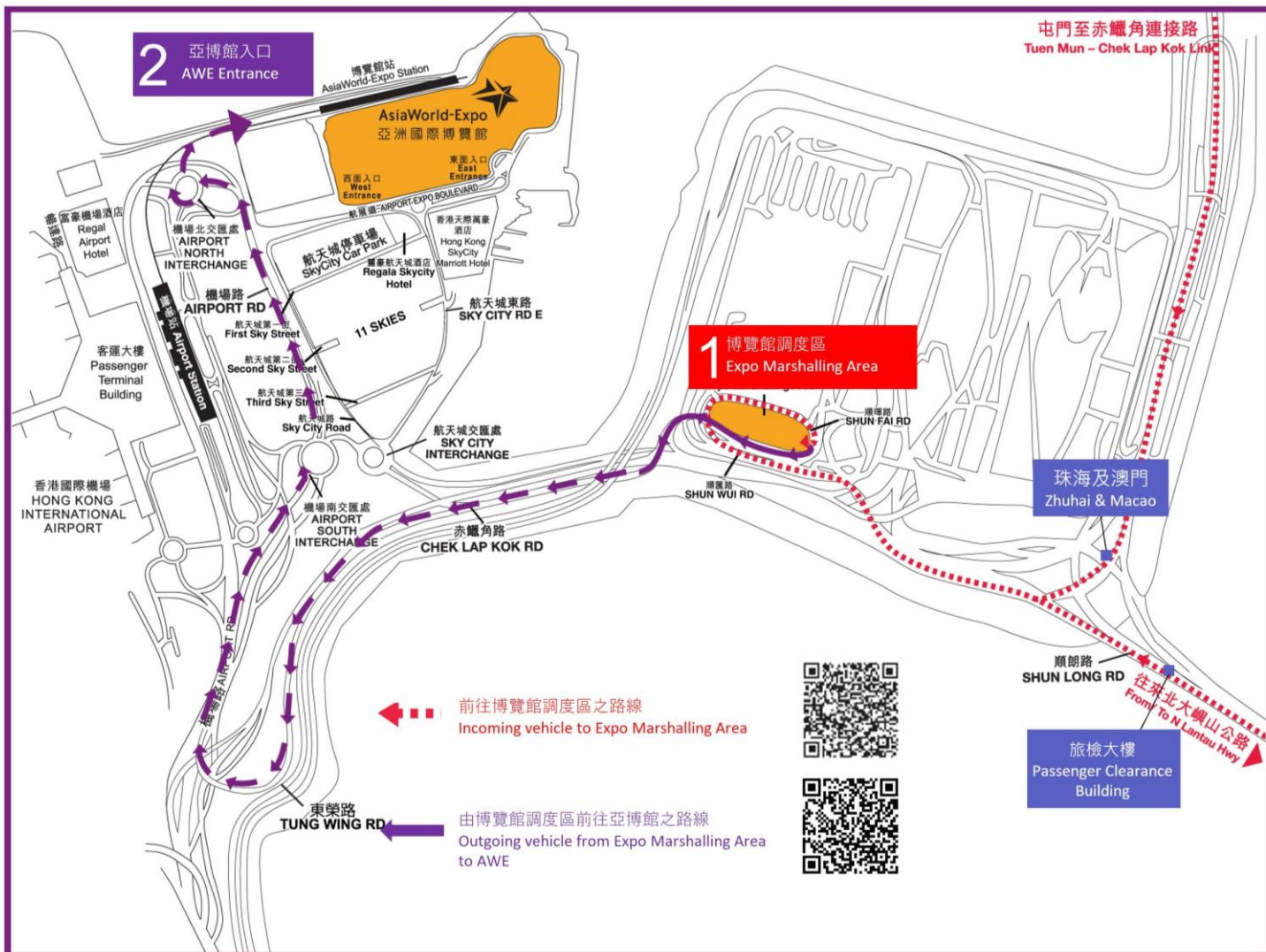

e-Vehicle Permit Sample 電子車輛許可證樣本



Event 活動名稱  
SEASONS | Spring Fashion Jewellery & Accessories Fair 2024

Class Type 類別  
Official 官方

Sub Type 子類別  
Contractor 承辦商

Allow In-out Time 允許進出時間  
2024-02-14, 08:00 - 2024-02-14, 23:00

Access Location 停車區域  
Hall 3

Remarks 備註



Suggested Driving Routes 建議駕駛路線

Go to AsiaWorld-Expo  
前往亞洲國際博覽館

Terms & conditions 條款及細則

1. All vehicles without a valid Goods Vehicle Permit will not be permitted to enter into the premises of AsiaWorld-Expo (hereinafter "AWE").
2. The driver must comply with instructions from the security personnel at all times within AWE.
3. The Goods Vehicle Permit is not transferable.
4. AWE or its authorized personnel reserve the right to refuse entry of any vehicle in possession of a valid Goods Vehicle Permit at their absolute discretion without prior notice and giving reasons.
5. All drivers must stay inside their vehicles at all times.
6. For unauthorised vehicles, only those equipped with and display an 40 feet or below will be allowed to enter AWE.
7. Trucks are allowed certain free dwell time depending on the vehicle type.

Overtime charges may apply as follows:

Vehicle Type / 車種	Charges / 收費
Private Car (7 seater only) / 私家車 (7 座或以下)	HK\$ 30/minute
Goods Vehicle (8 seater or below) / 貨車 (8 座或以下)	HK\$ 40/minute
Goods Vehicle (over 8 seater) / 貨車 (超過 8 座)	HK\$ 50/minute

Over-time Charges (per hour or part thereof):  
 - 1st Hour or part thereof: HK\$ 200  
 - 2nd Hour and thereafter: HK\$ 200

